

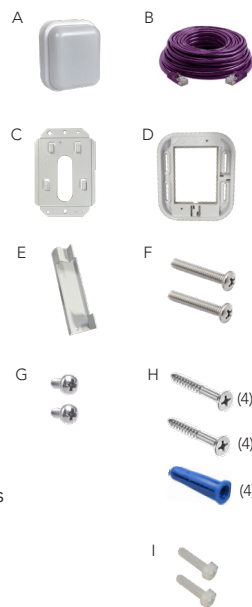

The ezRoom ClassLight is an important part of the ezRoom experience. It provides status for the system, such as power, mute, solo, page/intercom, or alerts. It also provides the IR transmission for the PrivaSee feature of the ELEVATE microphone system used in ezRoom. PrivaSee enables a microphone to mute automatically when the teacher leaves the room so they don't accidentally broadcast private conversations to the classroom.

Parts list

- ClassLight Assembly (A)
- 50ft/15m plenum Cat5e cable (B)
- Metal wall bracket (C)
- Plastic surface mount (D)
- Ceiling bracket (E)
- Screws for securing metal bracket to single gang box (F)
(2) #6-32 x 1" Phillips Screws
- Screws for securing metal wall bracket to plastic surface mount (G)
(2) M2.5 x 5mm bolts
- Screws for securing plastic surface mount to wall (H)
Wood: (4) #6 x 1-1/4" screws
Concrete/Drywall: (4) #6 x 1-1/4" screws
(4) Twist-Resistant Plastic Anchors
- Screws for securing ceiling bracket to ClassLight (I)
(2) M2.5 x 5mm bolts



Tools Required

- Phillips head screwdriver No. 2
- Cordless drill
- 1/8" (0.125") drill bit (for wooden stud)
- 7/32" (0.2188") drill bit (for concrete or drywall anchors, if installing on solid surface)
- Ladder
- Cable puller fish tape reel (if pulling the Cat5e cable through ceiling or walls)
- Plenum-rated plastic cable hangers or cable ties (if installing Cat5e cable in ceiling)

Wiring

The ClassLight includes a 50ft/15m plenum-rated UTP Cat5e cable with RJ45 connectors to connect the ClassLight to the ezRoom enclosure. This is considered a low voltage cable as it provides 12VDC power to the ClassLight. The plenum-rated cable jacket allows it to be installed in plenum spaces above a dropped ceiling if needed.

Wiring is very simple. At the appropriate time depending on installation, connect one end of the purple Cat5e cable to the back of the ClassLight, and the other end to the ClassLight port on the ELEVATE Base Station in the ezRoom enclosure (depending on version, may be labeled "Beacon Interface").

IMPORTANT: Follow all local codes and guidelines for low voltage cable installation when installing the ClassLight.

Location

The ClassLight can be installed in one of three ways:

1. Secured to a dropped ceiling
2. Mounted to a single gang wall box
3. Mounted to a solid surface (wall or ceiling)

The ClassLight is best positioned in a location where it can be seen by the teacher and students, for example in the front third of the room, on the ceiling or wall.

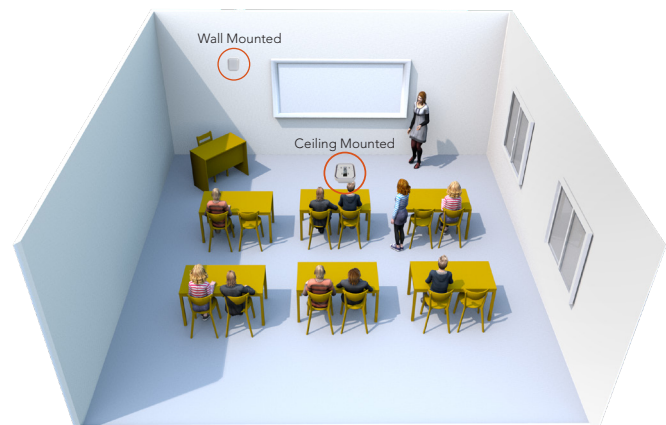

Secure to a dropped ceiling

1. Install and secure the ClassLight Cat5e cable from the ezRoom to the location where you want to hang the ClassLight.
2. Connect the Cat5e cable to the back of the ClassLight (Image 1)
3. Secure the ceiling bracket to back of the ClassLight using the (2) M2.5 x 5mm bolts (I). (Image 2)
4. Twist the ClassLight onto the dropped ceiling rail so that both sides of the bracket are secured against the rail. (Image 2)

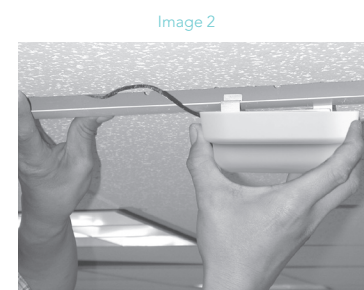
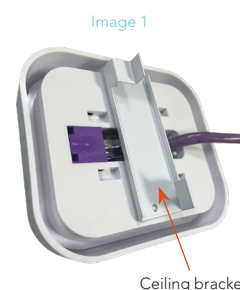

Mount to a Single Gang Wall Box

1. Install and secure the ClassLight Cat5e cable from the ezRoom to the opening in the single gang box.
2. Attach the metal bracket with the hooks facing out and up, to the single gang box using the screws (F) (Image 1)
3. Connect the Cat5e cable to the back of the ClassLight (Image 2)
4. Slide the ClassLight down onto the hooks of the metal bracket until it grips into place. (Image 3)

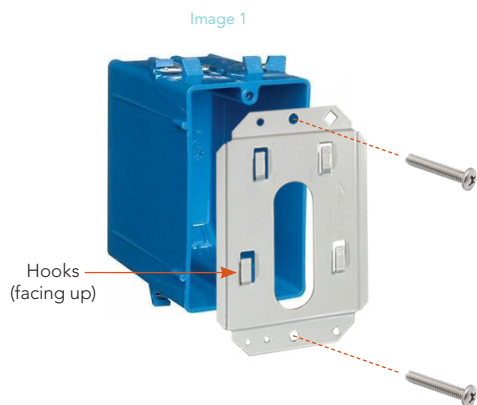

Mount onto a solid surface

1. Install and secure the ClassLight Cat5e cable from the ezRoom to the location of the ClassLight installation
2. Mark 4 holes for drilling, using the surface mount as guide. (Image 1)
3. Pre-drill holes as appropriate for concrete, drywall, or wood studs. Insert plastic anchors for concrete or drywall.
4. Pull Cat5e cable through center opening, and press into one of the cable slots.



5. Secure metal wall bracket to plastic surface mount with screws (G). Note the diamond cutout in the upper left, for proper fitting and orientation. Make sure Cat5e cable is pulled through the center of the metal wall bracket. (Image 2)

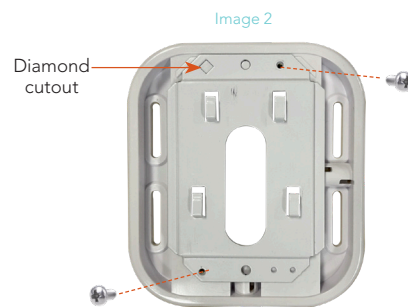

6. Connect the Cat5e to the back of the ClassLight.
7. Slide the ClassLight onto the hooks on the metal bracket until it grips into place. (Image 3)



Scan for complete User and Install Guide

Testing

Test to make sure the ClassLight is working by powering up the ezRoom. The light should turn green then white.

