

Action!™ Teacher Microphone Features

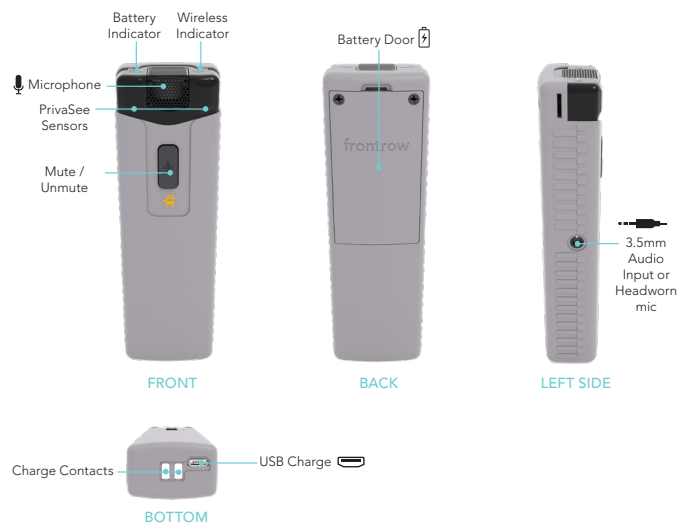

Bravo!™ Student Microphone Features



Getting Started

- Charge microphones completely before first use.
- There is no ON/OFF button for the ezRoom system or the microphones. They will “wake up” when they are picked up and “go to sleep” when not in use.
- Charge microphones every night by placing them in the charging cradle or via USB cable.
- The Action! and Bravo! Mics can be handheld, worn as pendant microphones, or clipped to a belt. If clipped to a belt, headset or lapel mic must be used.
- Microphone volume should be set so it is audible just above the background noise. If the teacher can hear themselves, it is probably too loud.

Status Indicators

Wireless Status

- Green solid** = Unmuted
- Amber slow fade** = Muted
- Green flashing** = Buttons active (no voice)
- Amber flashing** = Out of range of registered base stations
- Lights off** = Sleep mode

Battery Status

- Green** = Fully charged
- Green fade in-out** = Charging
- Red flash** = Low battery

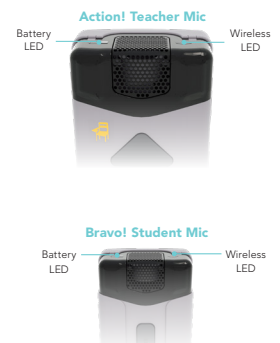

Batteries

Action! and Bravo! Mics use a rechargeable Lithium Polymer battery and will last up to 10 hours under normal use. All rechargeable batteries decrease their energy capacity over time. Change microphone batteries when the microphone will not hold a charge for the entire teaching day.

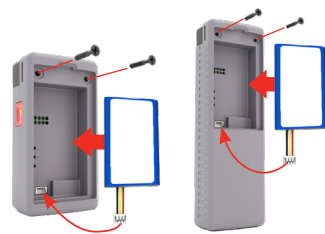

Battery Safety Warning

To reduce risk of fire or burns:

- Do not use batteries that have been dropped or otherwise damaged.
- Do not attempt to open, disassemble or service the battery pack.
- Do not use battery if exposed to moisture.
- Do not expose to temperatures above 40°C (104°F).
- Do not crush, puncture or short external contacts or dispose of in fire or water.
- Replace only with the battery pack designed for this product.



Charging



OR



NOTE: The mic will take a few seconds to wake up from charging.

Audio Level Reset

Press and hold the Mute button until it beeps 3 times to return the teacher mic to the default audio level.



Scan for complete User and Install Guide

Alert Buttons

Press and hold both buttons for 2 seconds (2 beeps) to activate an Alert. Alerts are custom configured for each school. Consult the installer or system administrator for Alert behavior.



Action Buttons

Action Buttons can be programmed to turn on displays, switch inputs, call the office, or more, depending on your class needs. The Action buttons may also light up to show if PrioriTeach, OptiVoice, Solo, or System Mute are engaged.



PrivaSee

Audio PrivaSee (if enabled) allows for private conversations by automatically muting the microphone when the teacher leaves the room. When the teacher re-enters the room, the microphone will automatically un-mute.

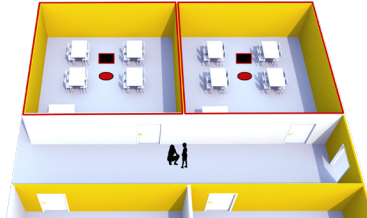

Connecting to a Room

Microphones must be registered with the Base Station in each classroom where they will be used. Once registered, the mic will always connect to that room and will not interfere with other rooms.

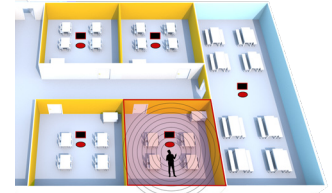

To Register a mic, press the Registration button on the Base Station, and hold down the Mute button on the mic for 5 seconds. (A button to activate registration mode can also be programmed to a FrontRow control panel or software).

Adjusting Lanyard

Pull or push lanyard to adjust length

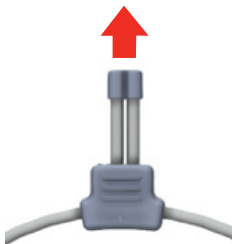

Pull to separate magnetic lanyard clip

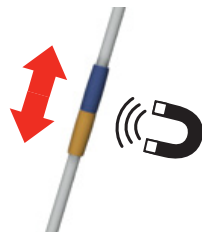

Change wearing options



Battery Door (with Belt Clip)

Teacher Microphone

Headworn microphone

*For best compatibility and performance, use only FrontRow-supplied headset and lapel microphones.

Cleaning

Microphones and Charger can be wiped clean using a damp cloth with common household disinfectants containing ammonia, alcohol or diluted bleach solutions. Do not use alcohol solutions with a concentration greater than 70%. Never immerse a microphone in water or any other liquid.



Important Safety Warnings

1. Read these instructions.
2. Keep these instructions.
3. Heed all warnings.
4. Follow all instructions.
5. Do not use this apparatus near water.
6. Do not block any ventilation openings. Install in accordance with the manufacturer's instructions.
7. Do not install near any heat sources such as radiators, heat registers, stoves, or other equipment (including amplifiers) that produce heat.
8. Do not defeat the safety purpose of the polarized or grounding-type plug. A polarized plug has two blades with one wider than the other. A grounding type plug has two blades and a third grounding prong. The wide blade or the third prong are provided for your safety. If the provided plug does not fit into your outlet, consult an electrician for replacement of the obsolete outlet.
9. Protect the power cord from being walked on or pinched particularly at plugs, convenience receptacles, and the point where they exit from the apparatus.
10. Only use attachments/ accessories specified by the manufacturer.
11. Unplug this apparatus during lightning storms or when unused for long periods of time.
12. Refer all servicing to qualified service personnel. Servicing is required when the apparatus has been damaged in any way, such as power-supply cord or plug is damaged, liquid has been spilled or objects have fallen into the apparatus, the apparatus has been exposed to rain or moisture, does not operate normally, or has been dropped.
13. The apparatus shall not be exposed to dripping nor splashing, and no objects filled with liquids shall be placed on the apparatus.

