

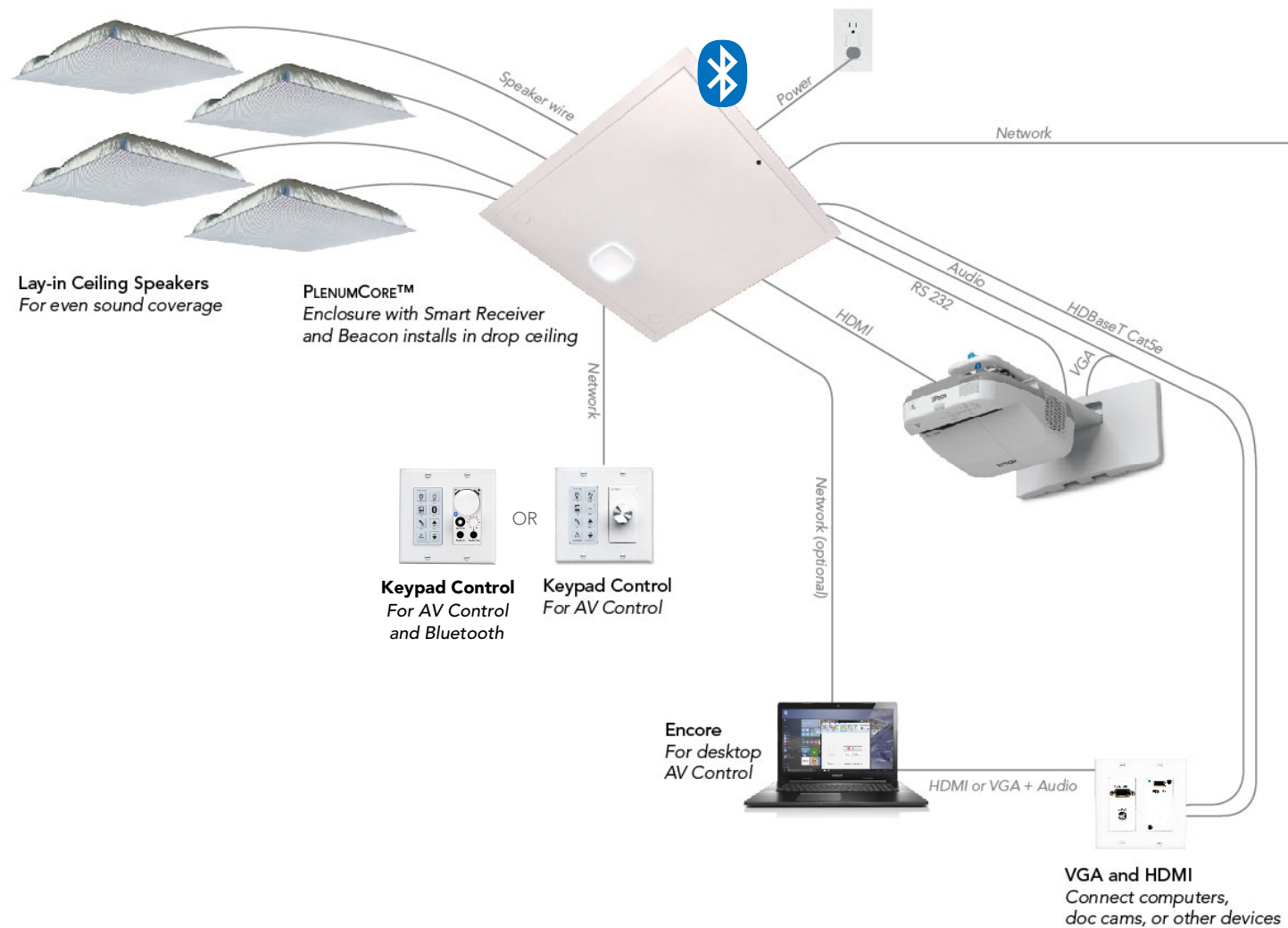

# **ezRoom Classroom AV Configuration Guide**

Fall 2019

# Example: Media Presentation



\*Projector, computer, and electrical outlet not included

## Example: Media Presentation + Voice Enhancement

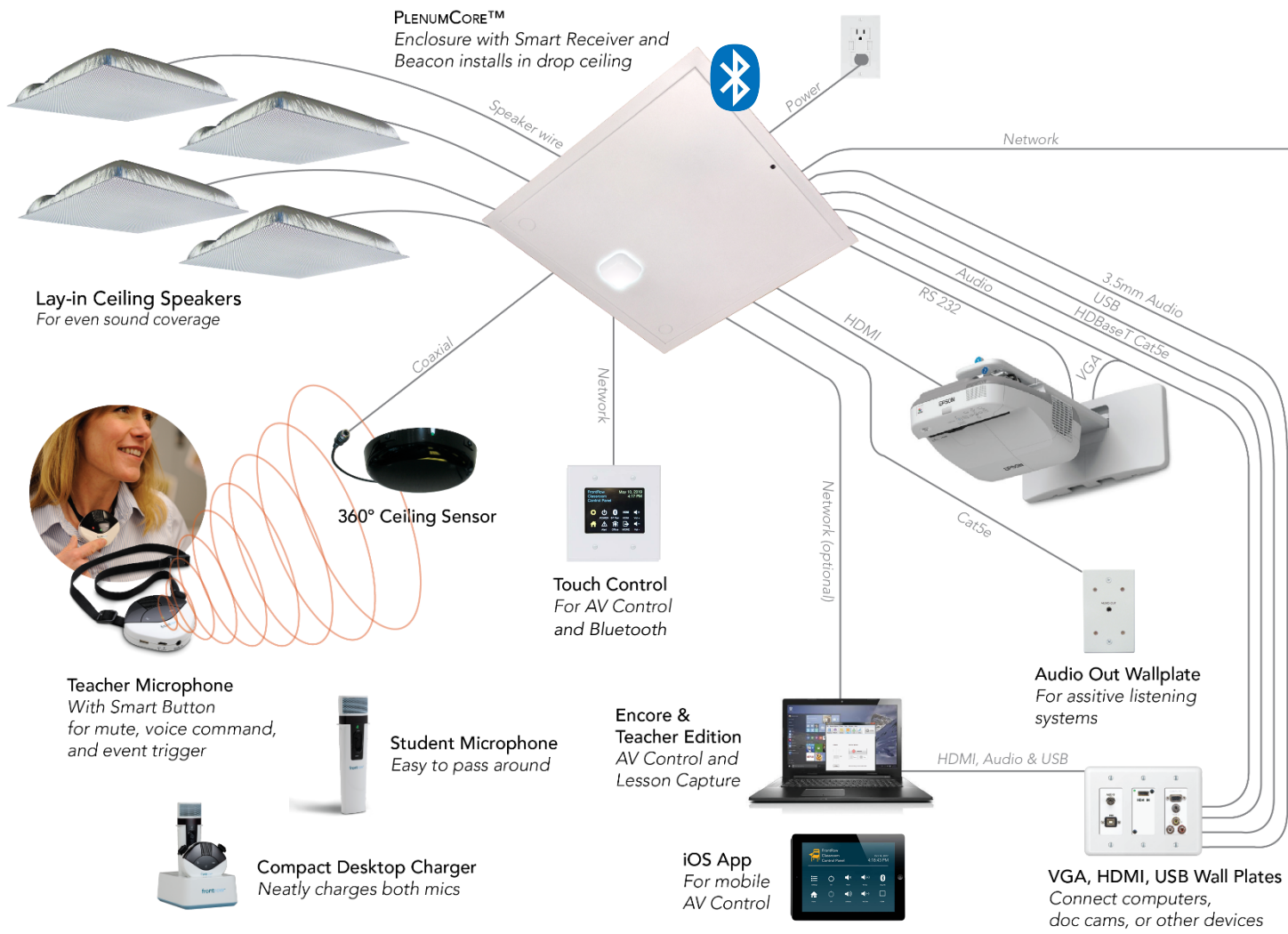

*\*Projector, computer, and electrical outlet not included*

# Create Your ezRoom

1

Base System

2

Microphones

3

Speakers & Sensors

4

AV Control

5

Options

6

Training and Service Plans

# 1

## Base System

### PlenumCore with Smart Receiver





The heart of the system, the FrontRow Smart Receiver is a networked amplifier, wireless mic receiver, signal processor, power distributor, and controller all in one, housed in a plenum rated 2x2 (US/CA) or 60x60cm (INT) enclosure designed for drop ceilings.

- Support 2 mics and 3 audio devices like computers, mobile phones, or Blu-ray players
- Adapto digital feedback suppression
- OptiVoice & Tune Up with 12-band digital EQ
- Voice command
- 2 audio outputs for lesson capture and assistive listening systems
- Network and serial connections for remote management and projector/display control
- IP Paging-ready
- LED Beacon visual feedback
- Includes network switch so only one drop to the classroom necessary
- Includes serial cable to connect to projector
- Connect HDMI devices like laptops and doc cams by adding the HDMI extender with audio de-embedding (HDMI-X1 for single HDMI, HDMI-X2 for dual HDMI).
- Add a power strip if installing other third party devices in the enclosure.

# 1

## More base systems

Ceiling Mount	WallCore	Ceiling Mount + HDMI	WallCore + HDMI
			
<p>Designed for rooms with drop ceilings. Plenum rated. Includes:</p> <ul style="list-style-type: none"> <li>• Network CM3000</li> <li>• Power supply</li> </ul>	<p>Mounts on the wall surface or directly over an electrical outlet. Includes:</p> <ul style="list-style-type: none"> <li>• Network CM3000</li> <li>• Power supply</li> </ul>	<p>Designed for rooms with drop ceilings. Includes:</p> <ul style="list-style-type: none"> <li>• Network CM3000</li> <li>• HDMI Extender w/ cables</li> <li>• Audio Extractor</li> <li>• Power supply</li> </ul>	<p>Mounts on the wall surface or directly over an electrical outlet. Includes:</p> <ul style="list-style-type: none"> <li>• Network CM3000</li> <li>• HDMI Extender w/ cables</li> <li>• Audio Extractor</li> <li>• Power supply</li> </ul>

For Symbio equipped configurations see price list

## 2

# Microphones

## Teacher & Student Mics



Better mics = better sound = better learning. Add up to two mics for the base system, or go for the 4 mic package which includes a teacher mic, 4 student mics, the channel expansion module, and 3 chargers. Perfect for larger classrooms or group/project learning.





FrontRow mics are designed to be easy to use, lightweight, and provide up to 8 hours of transmission before requiring recharge.

The teacher mic features a single Smart Button with quick press for mute, or hold down for voice command or any programmable event such as starting lesson capture or sending an alert to the office.

# 3

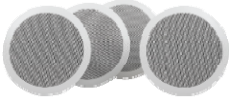
## Speakers & Sensors

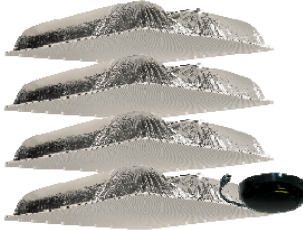
For systems with voice

Lay-in Ceiling Speakers	Circular Ceiling Speakers	IR Wall Speakers	Lay-in Speaker + Sensor	Circular Speakers + Sensor
				
Four 2x2, 8 Ohm lay-in ceiling speakers for drop ceilings. Includes plenum speaker cables.	Four 8 Ohm speakers for mounting into ceiling tiles. Includes 4 plenum speaker cables.	Two 4 Ohm speakers that mount easily to walls. Includes 2 plenum combo cables that combines the sensor cable with the speaker cable for easy installation. Our best sounding speakers!	Two 2x2, 8 Ohm lay-in ceiling speakers for drop ceilings and a ceiling sensor with cable. Includes plenum speaker cables.	Four 8 Ohm speakers for mounting into ceiling tiles and a ceiling sensor with cable. Includes 4 plenum speaker cables.







Add a speaker expansion module to double your wattage and speaker capacity. Comes pre-installed in the smart receiver.

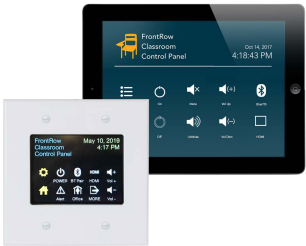

# 4

## AV Control

Keypad Controller	Keypad Controller Plus	Bluetooth Controller	Touch Controller + Mobile Control	Encore Desktop Control
				
<p>The CB2000 is an eight-button programmable &amp; networked keypad. Includes UTP cable, faceplate, and 48 buttons to choose from.</p>	<p>The 2050 is an eight-button programmable &amp; networked keypad plus volume/mute knob. Includes UTP cable, faceplate, and 48 buttons to choose from.</p>	<p>The CB55 wall-mounted volume control and pairing kit makes it simple to pair devices, set the appropriate volume level, and add additional wired audio sources</p>	<p>The CB6000 is a networked LCD touch-screen control with 40 programmable buttons. Includes UTP cable, faceplate.</p> <p>The Teacher Edition app for iPhone and iPad can be paired with any CB6000 for instant classroom control. Free download from the App Store.</p>	<p>Software for Mac and Windows. The perfect compliment to a CB6000, CB2000, or CB2050 control panel. Provides matching control panel experience for easy learning.</p> <p>Can also be used for PC Pop-up alert messages in emergencies.</p>

# 5

## Options

Power over Ethernet	Intercom Mics	Page Override	Lesson Capture	Bluetooth®	AV Wall Plate	Faceplates
						
<p>Provides power to the ezRoom for announcements in an emergency when used with Conductor.</p> <p>PD-20W works with CM3000-equipped systems.</p> <p>POE-X works with the Smart Receiver.</p>	<p>When using ezRoom with the FrontRow Conductor IP Paging system, add a hands-free room intercom mic to speak with the office.</p> <p>For international orders, add 330-2531-002 mounting bracket.</p>	<p>Connect to your existing analog paging system so that classroom audio is muted during PA announcements.</p> <p>Critical for important announcement and emergency situations!</p>	<p>Capture the computer screen and summed audio from the ezRoom with Teacher Edition capture software. The USB connection enables voice command for lesson capture as well as smart receiver settings. Includes all cables.</p> <p>(Use TE-CC-USB for both the capture and control licenses)</p>	<p>The CMBT audio receiver enables teachers to wirelessly play audio for the entire class through their ezRoom system. Adding the CB55 wall-mounted volume control and pairing kit makes it simple to pair devices, set the appropriate volume level, and add additional wired audio sources.</p>	<p>Decora® style wall plate and plenum AV snake cable for connecting a computer VGA and 3.5mm audio to your projector and amplifier. WP-PCAV adds composite support.</p> <p>For international orders, add 330-2531-002 mounting bracket.</p>	<p>Select the faceplate to match the number of AV input wall plates (VGA, HDMI, USB) in your order.</p>

# 6

## Training & Service Plans

### On-Site Training

### OOPS Coverage



Get 1, 2, or 3 days of on site hands on customized training from a FrontRow certified trainer. Specify your goals, focus areas, and a contact person, and we'll schedule a time to visit your school to train your staff on any of the FrontRow products. Typically this is used for schools that want the ability to configure FrontRow hardware or software using their IT team. Includes all travel expenses.

(North America Only)

The OOPS program provides free replacement of product damaged by spills, drops, theft, and other classroom mishaps in 3 days or less. It even covers worn out rechargeable batteries and mics. (NONE OF THESE ARE COVERED BY THE STANDARD 5-YEAR WARRANTY!) Select from 1-5 year plans.

Details at

<https://www.gofrontrow.com/sites/default/files/service/frontrow-service-oops-flyer-us.pdf> (US Only)